

What does the self test look like?

The Evalyn[®]Brush is about 20cm in length and consists of a transparent case with wings. Within the casing is a pink stick with a pink plunger at one end and a white brush at the other. At the brush ends, a pink cap can be clicked onto the case. When you take off the cap, you can push the white brush out of the case by pushing the pink plunger towards the transparent casing.

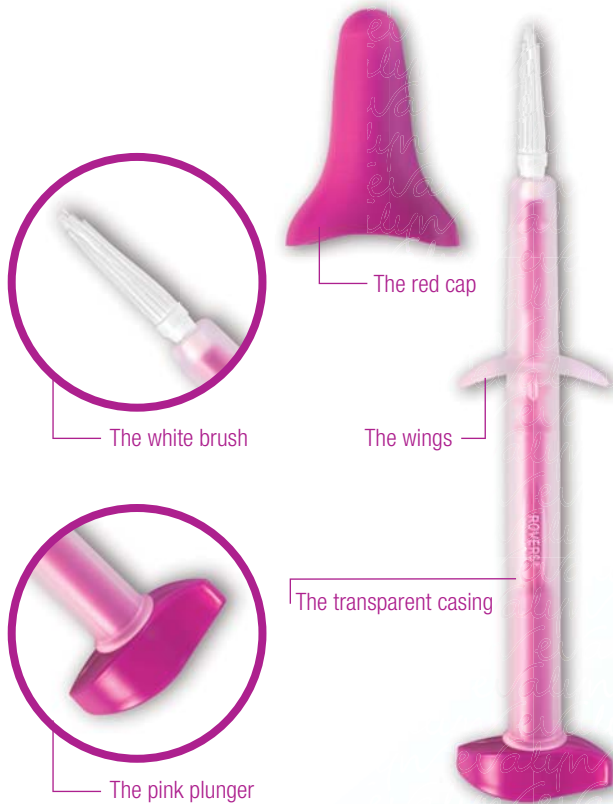

Why use the Evalyn[®]Brush?

The Evalyn[®]Brush is a device developed specially for the retrieval of cell material from the vagina. The Evalyn[®]Brush is equipped with a brush with fine bristles, ensuring that you collect enough cell material.

Rovers Medical Devices

Rovers Medical Devices specialises in the development of devices for the retrieval of cell samples for medical research. The safety and reliability of the products is guaranteed by the years of experience that Rovers Medical Devices has in the development, research and production of a wide variety of medical research products. The Rovers[®] Cervex Brush[®] – known globally for its innovative swab – is part of the product range of Rovers Medical Devices.

Instructions for the home test

Version Evafd-2011-09-EN



Manufacturer: [Rovers Medical Devices BV](http://www.roversmedicaldevices.com)
Lekstraat 10, 5347 KV Oss, the Netherlands
Tel: +31 412 648870
Fax: +31 412 623835
E-mail: info@roversmedicaldevices.com
Website: www.roversmedicaldevices.com



Rovers[®] Evalyn[®]Brush is a patented product and a registered design.
Rovers[®] and Evalyn[®] are registered trademarks of Rovers Medical Devices B.V. Oss, the Netherlands.
© Rovers Medical Devices B.V.

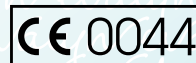

Simple, safe and reliable

These instructions apply to the usage of the Evalyn[®]Brush.

The Evalyn[®]Brush

The Evalyn[®]Brush is a sterile device that allows you to carry out tests yourself at home. Using the Evalyn[®]Brush, you can retrieve vaginal cell material simply and painlessly. This cell material is then analysed in a professional laboratory.

Important notes

- Do not use if the packaging of the Evalyn[®]Brush is damaged or if the expiry date has passed.
- Do not use during menstruation.
- Do not use during pregnancy or for three months following pregnancy.
- Do not use any other vaginal products for at least two days before using the Evalyn[®]Brush. Vaginal contraceptives, condoms and water-based lubricants can be used as normal.
- For single use only.
- Re-use can result in infection and/or incorrect diagnosis.



1. Wash your hands before usage.

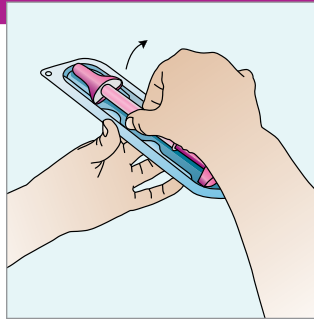

2. Remove the Evalyn[®]Brush from the packaging. Do not throw the packaging away, as it is necessary for sending the Evalyn[®]Brush to the laboratory after usage.

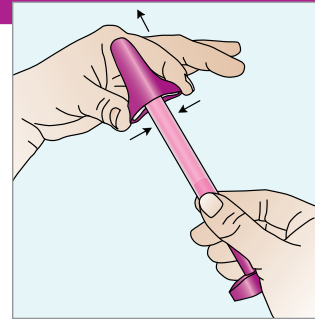

3. Press the sides of the pink cap with your thumb and index finger to remove the pink cap from the Evalyn[®]Brush. Ensure that you do not touch the white fibres of the Evalyn[®]Brush with your hands!

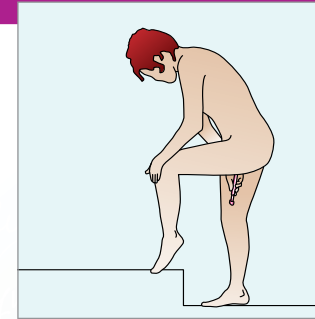

4. Obtain the sample whilst in a standing position. Assume a comfortable stance (e.g. as if you were about to insert a tampon).

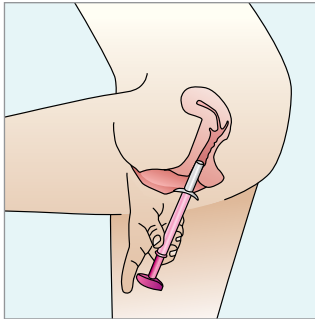

5. Spread your labia with one hand, and with the other, insert the Evalyn[®]Brush into your vagina until the wings touch your labia.

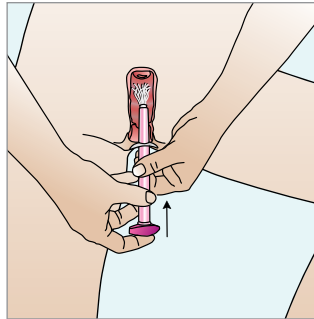

6. Hold the transparent casing with one hand, and with your other hand, push the pink plunger in the direction of the transparent casing. You will hear and feel a click when the brush is in the right position with the pink plunger directly against the casing.

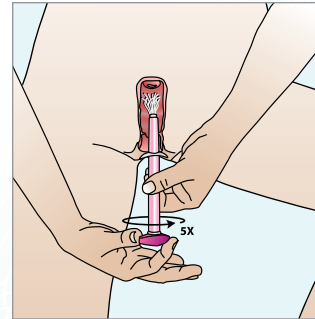

7. Turn the pink plunger five rotations in the same direction. After each rotation, you will hear a click. This helps you count the rotations. After turning the plunger five times, carefully remove the Evalyn[®]Brush.

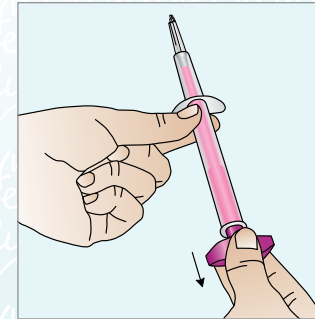

8. Hold the transparent casing with one hand, and with your other hand, pull on the pink plunger until the white brush disappears into the casing. When doing so, do not touch the top part of the Evalyn[®]Brush above the wings.

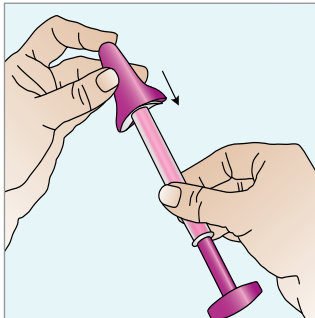

9. Hold the transparent end to ensure the white brush does not extend again. Place the pink cap back on the Evalyn[®]Brush using your thumb and index finger. You will hear a click when it is properly in place.

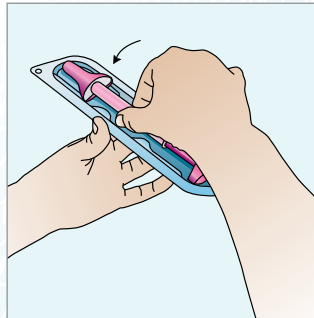

10. Put the Evalyn[®]Brush back inside the packaging.

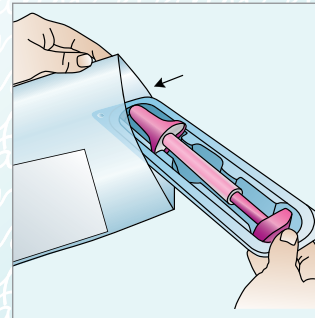

11. Place the packaging containing the Evalyn[®]Brush into the plastic bag provided and seal it.

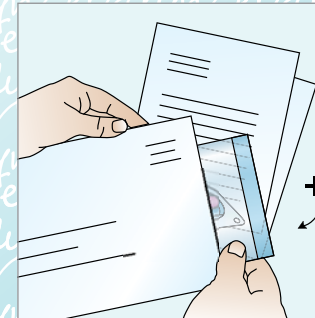

12. Use the return envelope to send the plastic bag containing the Evalyn[®]Brush, together with the signed declaration of consent and the completed questionnaire.